



Huber Kontech AG

From measurement to production – how Huber Kontech is rethinking complex metal engineering projects with HiCAD

For over six decades, Huber Kontech AG has been synonymous with precision craftsmanship and innovative solutions in metal engineering. Founded in 1962, this family-run business has established itself in a wide range of sectors – from traditional metal engineering and gates to glazing systems and modern stable design concepts for animal-friendly facilities. What all these projects have in common is individual solutions from a single source. From the first draft through to production and installation, right through to maintenance services, Huber Kontech supports its customers throughout the entire life cycle of a project.

When structural design has to do more than just draw

The demands of modern metal engineering are high. Structures must not only be technically precise, but must also comply with standards for structural engineering, thermal insulation, sound insulation and fire protection – whilst meeting the design vision of architects and clients.



HUBER KONTECH

MEHR ALS METALL UND BAU SEIT 1962

REFERENCE REPORT

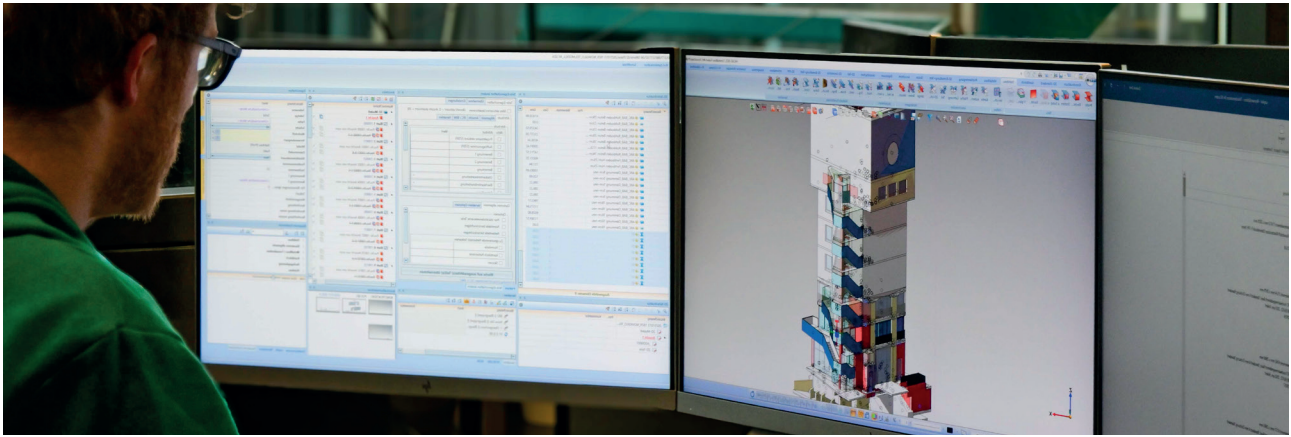

Image: ©Huber Kontech AG

This is exactly where HiCAD comes in. Huber Kontech currently uses several modules, including the Metal Engineering Suite, Metal Engineering Suite Premium, Point Clouds, and an IFC interface for BIM projects.

The seamless link between planning and production is particularly important for the company. Drawings can be linked directly to the LogiKal software via interface. At the same time, sheet metal and piping drawings can be transferred as 3D data directly to machines such as tube lasers or flatbed lasers.

The result: faster processes, fewer manual steps and significantly lower error rates.

Digital measurement: Point clouds as a game-changer

Another key component of the digital workflow is working with point clouds. Huber Kontech uses the Leica BLK360 for measurement and as-built documentation.

The advantages are obvious:

- significantly more precise measurements,
- less time spent on site,
- and direct processing of the data in the drawing.

“The ability to process our measurements quickly and start planning directly in HiCAD is a real game-changer for us,” explains the company.

Particularly in complex construction projects, the visual representation of point clouds provides additional certainty – both for planning and for communication with clients.

The move from multiple systems to one universal solution

Before introducing HiCAD, Huber Kontech worked with a mix of various systems: drawings were mainly created in AutoCAD using Athena, whilst sheet metal drawings were developed using SolidWorks.

As project complexity increased, so did the need for an universal solution that would link planning, design and manufacturing more closely.

The objectives were clearly defined:

- more efficient project workflows
- more accurate production documentation
- clear detailed planning
- effective interfaces with machines and systems

Following an in-depth evaluation of various solutions, the decision was ultimately made in favour of HiCAD. The main deciding factors were its wide range of applications in metal, steel and sheet metal fabrication, its automation functions and its integration with the existing machinery.



“Thanks to practical support tailored to our needs, we were able to implement our first projects quickly. The 3D capabilities enable us to plan even complex projects with confidence and carry them out successfully – projects that we would hardly have taken on without these features.”

Huber Kontech AG

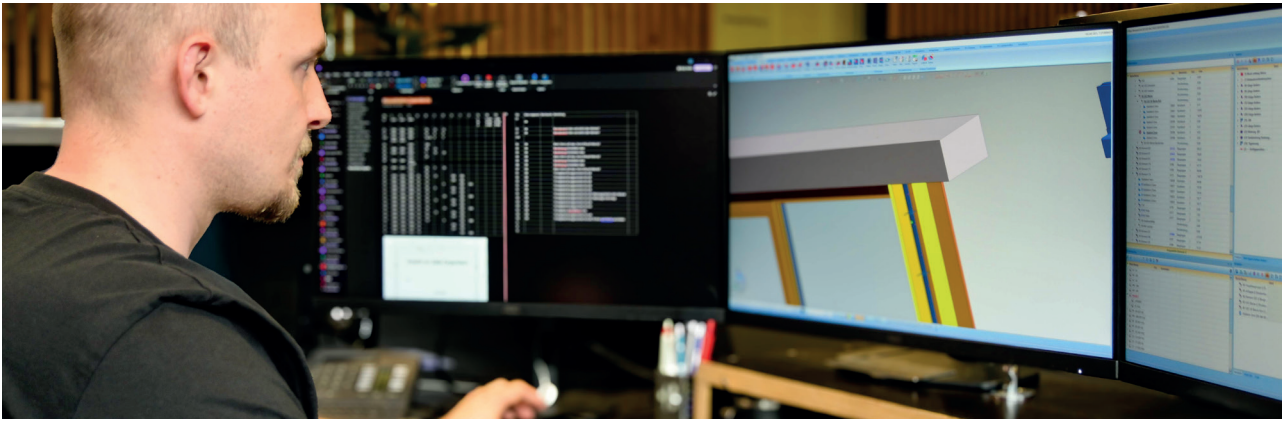

Image: ©Huber Kontech AG

A learning curve that paid off

Getting to grips with HiCAD was an intensive process – particularly for staff who had previously worked exclusively in 2D. Yet it was precisely this difference that proved to be an advantage in the long run. Our trainee metalwork designers have been familiar with 3D design right from the start of their training.

This is because HiCAD requires a structured way of thinking right from the design stage, where parts, dependencies and information are clearly organised from the outset.

“You quickly realise that it’s not just about an extra dimension. Right from the start, the model contains significantly more information than a traditional 2D drawing,” says the team, describing their experience.

As they gained more experience, the real added value became apparent: automatic drawing derivations, parametric drawings and consistent data for process planning and production.

Processes up to 60% faster

Today, a large part of the production documentation at Huber Kontech is generated automatically from the 3D model. Bills of materials, detail drawings and manufacturing data are generated directly from the drawing and processed digitally.

Looking at the entire project workflow – from site measuring through to planning, bill of materials creation and machine control – the result is an impressive improvement:

a 40 to 60 per cent increase in efficiency across the entire process.

A wide range of applications – from facades to livestock housing

The range of applications for HiCAD mirrors the diversity of projects. Huber Kontech uses the software for, amongst other things:

- building shells such as facades, as well as window and door systems
- a wide variety of gate systems
- traditional metal engineering and glazing constructions
- livestock housing structures
- ventilation and air purification systems
- light steel engineering
- sheet metal structures ranging from thin to thick sheet in aluminium, steel and stainless steel

Thanks to the IFC interface, these models can also be easily integrated into BIM projects and shared with other project participants.



“Although implementing HiCAD was time-consuming for us, it was definitely worth it. Despite the effort involved, we would take this step again in a heartbeat, because the benefits it brings to our day-to-day work and to drawing production more than justify the investment.”

Huber Kontech AG

Partnership on equal terms

In addition to the software, the collaboration with the ISD Group also plays an important role.

Huber Kontech describes the interaction as open, direct and solution-oriented. Concerns are taken seriously, support enquiries are answered quickly and technical improvements are implemented on an ongoing basis.

“You’re dealing with an ambitious team that almost always finds a solution,” the company says, summarising its experience.

A step that made a big difference

Today, HiCAD is a central component of Huber Kontech’s digital infrastructure. The next steps are already planned – including an ERP integration and possible extensions to the software licences.

In brief

- › [Huber Kontech AG](#)
- › [Industry: Metal engineering](#)
- › [Software: HiCAD](#)
- › info@huber-kontech.ch



Image: ©Huber Kontech AG



Success requires a strong partner

See for yourself what our solutions have to offer. We’d be happy to show you further details during a personal presentation or a free consultation. Simply get in touch - we’re here to help.

ISD Software und Systeme GmbH

Tel.: +49-(0)231-9793-0

Mail: info@isdgroup.com

Web: www.isdgroup.com